

# SBVC BOND & NON-BOND PROJECTS

May 23, 2016

- EXISTING CONSTRUCTION FENCE THROUGH JUNE 30, 2017 - KITCHELL/BRJ YARD
- EXISTING CONSTRUCTION FENCE FOR PROJECTS
- CONSTRUCTION AREA FOR PROJECTS

**NOTE:**  
ALL CONSTRUCTION DATES ARE PLANNED "TENTATIVE" DATES AND SUBJECT TO CHANGE DUE TO UNFORESEEN CONDITIONS, WEATHER INCLEMENT, AND OUTSIDE REGULATORY AGENCIES' ACCEPTANCE. THE STAKEHOLDER WILL BE NOTIFIED OF ANY CHANGES.

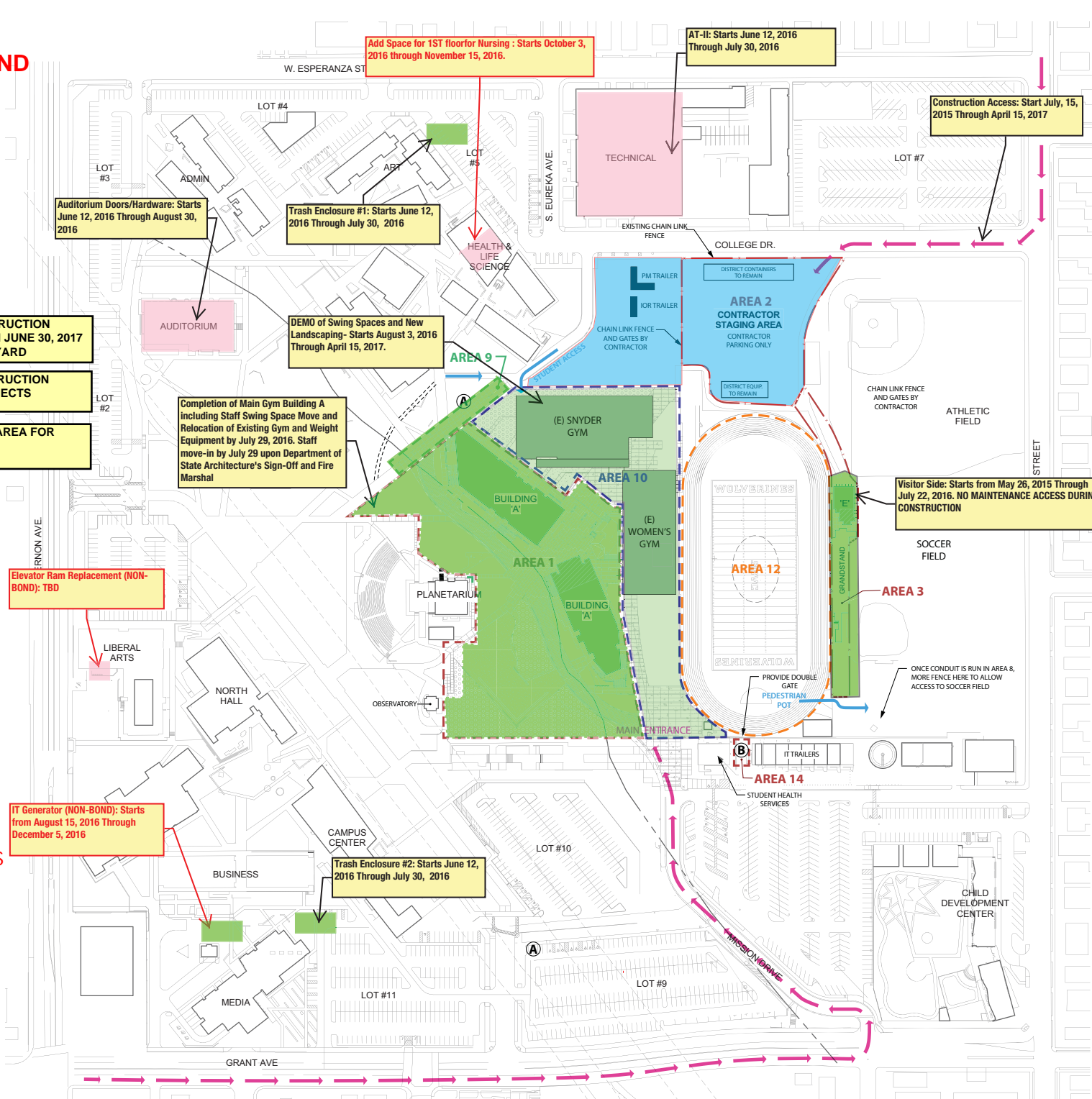

**Notes:**

- Dates are for construction durations only.
- Contact information for the Campus Director of Facilities:
- Robert Jenkins  
909-693-0314
- Contact information for Construction:
- Office: 909-693-3160
- Bond Program- Hussain Agah, Kitchell/BRJ
- Non-Bond Program- Ricardo Cano, Monica Garza, Kitchell

**COMMENCEMENT DATE:**  
Friday, May 27, 2016  
No Construction Activities;  
Construction Shutdown

## Campus-Wide Projects Non-Bond:

- \* Roof Building and Envelop Repairs: Starts from June 13, 2016 Through August 5, 2016
- \* Fire Alarm Panel Replacement: LA, Planetarium, Applied Tech, and M&O): Starts from August 15, 2016 Through November 18, 2016
- \* Campus-Wide Lockdown: Starts from April 19, 2016 Through August 12, 2016
- \* Campus-Wide parking Lots Resurfacing: Starts from June 13, 2016 Through July 29, 2016